

A photograph of a dense bamboo forest. In the foreground, a light brown dirt path curves from the bottom left towards the right. The background is filled with tall, lush green bamboo stalks and leaves, creating a thick canopy. The sky is visible at the top, showing a clear blue gradient. The overall scene is bright and natural.

SYMPHONY FOREST PARK

Bodakdev, Ahmedabad

Project Details

Title: Symphony Forest Park
Developed By: Symphony Limited
Owned by: Amdavad Municipal Corporation
Area: 11,017 sq mts
Location: TP-50 Bodakdev, FP-361+26
Architects: urbscapes and Modo Design
Landscape Architect: urbscapes
Construction: Bakeri Group

Copyright

Title: Symphony Forest Park, Bodakdev, Ahmedabad
Author: urbscapes

[2019], urbscapes
Project documentation monograph.
studiourbscapes@gmail.com

This publication is not for COMMERCIAL USE.
ALL RIGHTS RESERVED. All the graphics in the book have been delineated by the author under 'Symphony Forest Park, Bodakdev, Ahmedabad'.
All photos/images are by the author unless specified.
Birds images/photos and plant species photos have been taken from various sources of internet.

Any unauthorized reprint or use of this material is prohibited.
No part of this book may be reproduced or transmitted in any form or by any means, electronic or mechanical, including photocopying, recording, or by any information storage and retrieval system without written permission from the author.

Content

Forest - An idea	04
Place	06
Formulation	10
Execution	16
Glimpses	22
Flora- Fauna	32

Forest - An idea

The city of Ahmedabad spread over 400 sq kms now, has a built density of 35% and over 2500 ha. of Public land. A part of this land goes into parks and gardens, which caters to the daily needs of citizens of all ages - providing playing areas for children to seating and walking areas for senior citizen seating.

But, can our city parks be mini forests? Can we have a forest amidst dense urban built form? A park which has its own ecosystem, where birds chirp, squirrels squeak, fish and turtles click. An experience of forest - with raw, rustic and meandering pathways, with rocks and boulders, covered with dense trees, planted in natural disorder, suggesting seasons, inviting bees and butterflies.

Symphony Limited has its corporate office building in Bodakdev, off SG Highway in western Ahmedabad. Opposite the building is a 11,017 sq. meters plot of land owned by the Ahmedabad Municipal Corporation (AMC) which is designated for a public garden. Being a company devoted to environmentally friendly products, Symphony wished to contribute to the environment by developing this garden. Symphony sought and was granted permission by the AMC to develop the garden on a public-private-partnership (PPP) basis as part of its CSR activities. The Symphony Forest Park is a result of this.

The plot had a small pond which has been retained and developed. There are a couple of temples inside the property but close to the edge, which have been retained and provided direct access from the road.

The surrounding area consists mainly of commercial buildings. The garden will therefore primarily used by officegoers of the nearby buildings during their breaks. There are a couple of other "family gardens" developed by AMC within a few hundred meters of the proposed garden. These gardens have lawns, children's play area, party lawns, walking tracks etc. and adequately serve the needs of the surrounding residential communities.

Considering all the above, the garden has been envisaged and developed as a small urban forest, a 'lung', with a bio-diverse mix of large, shade-giving trees. Trees which attract birds and butterflies. Upon maturing in a few years, the forest will have a very natural feel, with under-growth, undulating levels, unpaved and meandering tracks and minimal hardscape. The existing pond is reconfigured in to a shallow, but a wider waterbody which hosts fish, frogs and turtles.

The forest park provides visitor's parking along its periphery, has amenities, security and adequate lighting. Once fully grown and developed, this will become an ideal place for intellectuals, children, those who appreciate nature and landscape, bird photographers and for people who wish to spend time with oneself.

It is with great pleasure that Symphony dedicates this little oasis to the citizens of Ahmadabad.

Achal Bakeri
Symphony Limited
January 2020



Place

The park is located at Bodakdev, Ahmedabad. It is surrounded by upcoming residential neighborhoods and established commercial/office buildings. The corporate staff as well as the nearby residents will be the primary users of the forest park.

It was an empty land owned by AMC, which had few existing trees which attracted birds, a lake which was partially filled with debris. The challenge was to work with the flat topography of the plot which was filled with debris and waste. The plot has access from three sides with the south shared with private residences and an apartment building.





Site showing the dry lake , waste and debris



Trees surrounded by debris



Debris in the site area



Banyan tree



Garbage in the site area



Site showing the dry lake , waste and debris

Formulation

With Forest - An Idea, the design process began with experiences of a forest. The meandering trails, undiscovered pathways, dense cover of trees, variety of leaves, fruits, flowers, bushes, raw - rustic setting. These key words became the soul of the project.

The design process involved mapping of existing trees with their foliage cover, bird species, topography, context and access points. The existing topography was altered with cut and fill method to achieve the desired mounds and create planting islands.





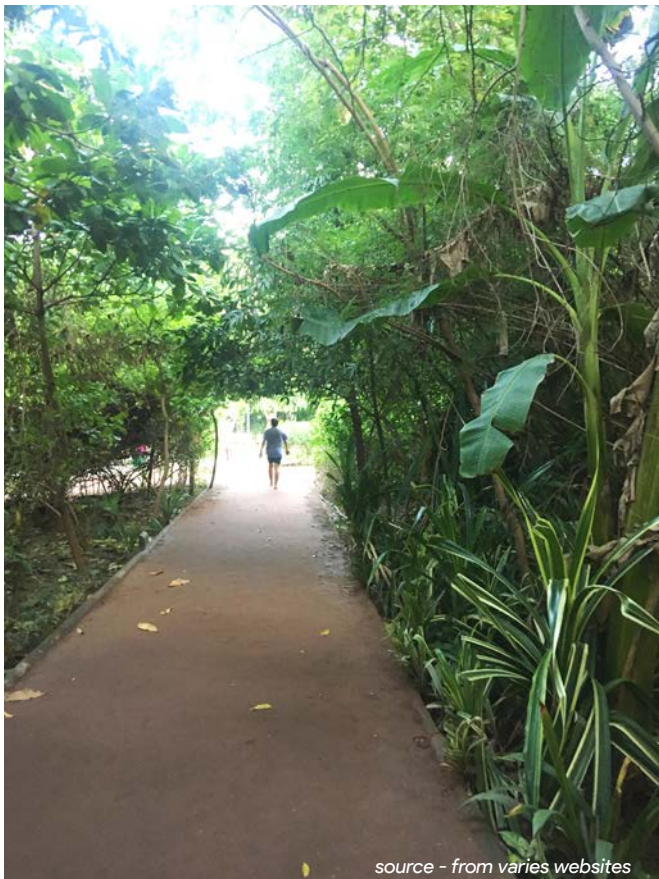
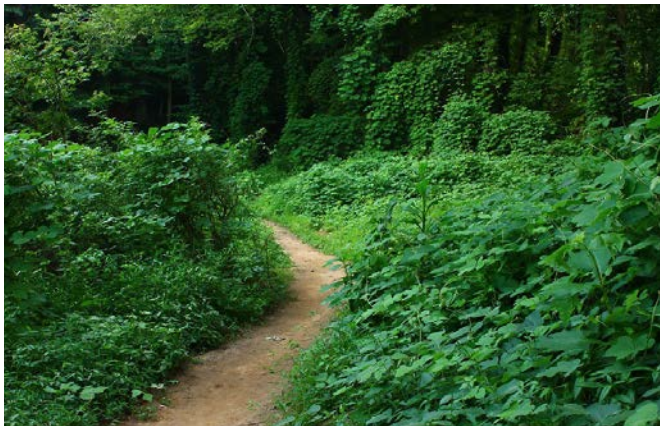



The place is imagined to be rustic, raw and natural. These images here, are representation of what this park will be in the coming years with full grown trees, boulders become part of the setting as if they were always there since the beginning of time and benches also become part of the natural setting.







Legend:

1. Entrance
2. Entrance Plaza
3. Security cabin and Utility block
4. Water Place and Toilets
5. Retained Bamboo Plantation
6. Brick Walkway with Seating
7. Bridge
8. Walkway along Water edge
9. Lake
10. Entrance to Dense Plantation
11. Walkway from Dense Plantation
12. Walkway from Tall Plantation
13. Walkway within Grassland
14. Walkway with Both Side bamboo Plantation
15. Walkway from Dense Plantation
16. Walkway along Tall Trees
17. Mound
18. Amphitheatre
19. Children's Play Area
20. Service Gate
21. Parking
22. Temple Gate
23. Temple Ground

Execution

The process of making began with site clearance, removal of debris, re-establishing boundaries and removing garbage.

Each component of the park required a different skill set, from building the facility block, to realigning the lake form, planting zones, irrigation, lighting and signage.

Inspired by the Japanese afforestation method - "Miyawaki", the planting zones were developed by mixing rice husk, coco peat, cow dung and soil, the saplings are grown in proximity.



Site Meeting



Site observation



Lake line out



Planting saplings on "World Environment Day - 5th June, 2019"



Excavation



Lake edge in process



Mud plastering on brick pitching



Layering of coco pith and rise husk



Marking grid on site



Preparing base with RCC layer



Layering of "metal stone"



Layering of "charru"



Tar road construction process at West side compound wall



Placing boulder on mound



Finishing process of seating at children play area



Wall construction process



SANGATI SPIRAL

Sculpture - Sangati - Symphony of Nature

Mild Steel and Mirror

Sangati takes its reference from Beethoven's Symphony 5. The ten columns and eight fins with mirror, stretch towards the sky like Symphony 5 around a spiral that reaches its peak played by a well synchronized orchestra and shall continue to grow. These columns and fins dictate the notes of piano which are part of the musical composition.

The sculpture is inspired by the idea of Symphony of nature through an elaborate composition of man, flora, fauna, soil, water and light, and uses Beethoven's Symphony 5 as a metaphor. The columns as notes refer to flora, fauna, soil, water and light while mirrors refer to you the viewer. The Symphony of nature is incomplete without you.

This park is an attempt to symphonize these elements to compose a Symphony of nature. Given the sculpture's distinctive form, and its prominent location at the main entrance of the park, Sangati is a nod to this Symphony of nature.



SCULPTURE - SANGATI



Mural - Sanyojan at Entrance plaza

Mural - Sanyojan

Metal scrap

Sanyojan, is inspired from the idea of composition in nature. All elements of nature play their respective roles in creating the ecosystem, and always hold on to their individual existence. These elements although complete, are always part of the larger process of composition. Trees, birds, insects, water, earth, soil, light and man are all parts of this system.

The mural depicts the assembly of these parts by showing the larger idea of the composition which is always in progress, wherein each elements play their roles. The mural shows how these elements unite to create the system and you the viewer is part of this composition.

The mural is a welcome as well as a gesture of gratitude to you. If you are reading this while starting your journey to the park, you are going to become part of the composition with the other elements, while if you are viewing at the end of your journey, you are taking break from this ecosystem and we wish you see you again...

Glimpses

Symphony Forest Park will take few years to develop fully - for trees to grow, for shrubs to flower, for earth to settle, and for rocks to adjust. It will take its own time for the ecosystem to develop, bees to make their hives, birds to build their nests, and frogs to find their place.

It has become a new place to live, for the birds, bats and squirrel. As time cascades, the park will transform into a dense ecological pocket affecting the microclimate of the neighborhood. Meanwhile here are few glimpses of the forest, showing how can we make an oasis amidst urban density.





Water edge with dense plantation



Main Entrance



Entrance plaza



Brick walkway



Bridge crossing the lake

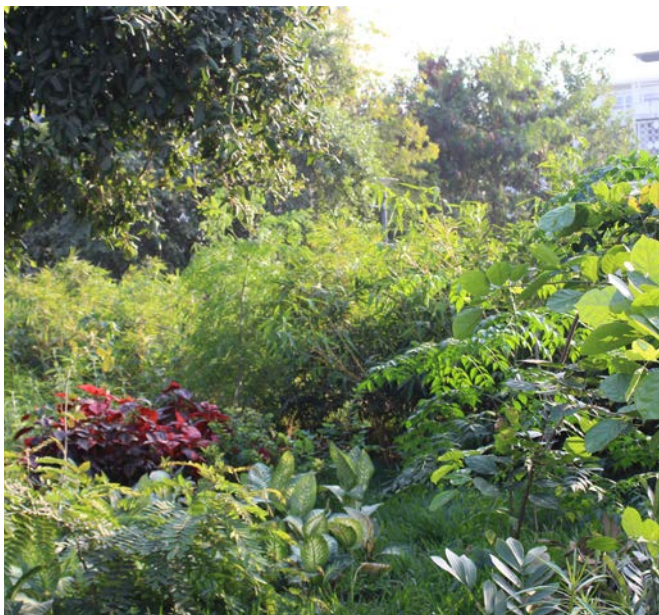

Dense plantation



Walkway from Bamboo plantation













Flora-Fauna

Forest park now is home to 300+ species of plants and probably 30+ species of birds visit. The forest has been planted with over 25000 plants, few of which are rare, many of them of mythological, religious and ecological value.

The park has plenty of fruit bearing trees, flowering shrubs to invite birds, insects, bees and squirrels. The park is also home to common bats.



Azadirachta indica



Butea Monosperma



Ficus Benghalensis



Ficus Religiosa



Delonix Regia

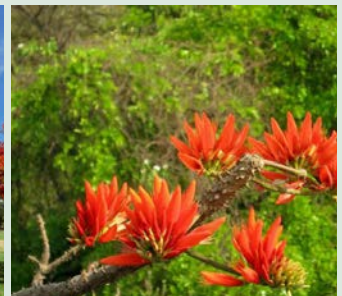

Erythrina Suberosa



Madhuca Longifolia



Phyllanthus Emblica



B.balcooa



Zephyranthes candida



Areca palm



Water lilly mix color



Bambusa multiplex



Hemerocallis fulva



Livistona chinensis



Pistia stratiotes



Bambusa ventricosa



Hymenocallis littoralis



Rhapis excelsa



Thalia dealbata



Terminalia Peruviana



Water lily Blue



Zamia Palm



Cyperus Papyrus



Acacia Ferruginea



Albizia Lebbeck



Callistemon Lanceolatus



Melia Azadirachta



Spathodea Campanulata



Lagerstroemia Parviflora



Tecomella Undulata



Mimusops Elengi



Bombax Ceiba



Bauhinia Blackeana



Cordia Sebestena



Terminalia Bellirica



Cassia Fistula



Sterculia Urens



Parkinsonia Aculeata



Pithecellobium Dulce



Aegle Marmelos



Alstonia Scholaris



Millingtonia Hortensis



Manilkara Hexandra

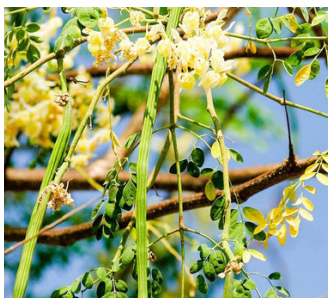

Moringa Oleifera



Anthocephalus



Tamarix Aphylla



Tamarindus Indica



Mangifera Indica



Erythrina Indica Picta



Thespesia Populnea



Schleichera Oleosa



Calophyllum Inophyllum

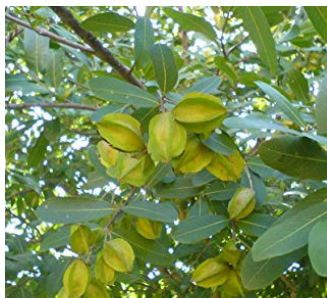

Arjuna



Thevetia Peruviana



Mitragyna Parvifolia

source - from varies websites



Ixora Parviflora



Ixora Singaporensis



Allamanda Neriifolia



Dombeya Wallichii



Murraya Exotica



Mussaenda Rosa

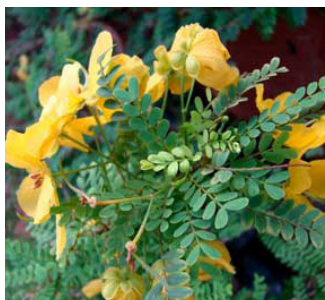

Cassia Biflora



Eranthemum Roseum



Adadoythda Vasica



Hibiscus Rosa-Sinensis



Thryallis glauca syn.



Stachytarpheta Indica



Tabernaemontana coronaria



Nerium Oleander



Tecoma Gaudichaudi



Vitex Nigundo



Lantana Camara



Jasminum Sambac

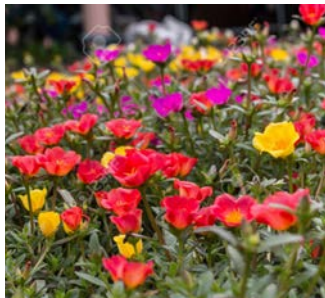

Portulaca Oleracea



Spathiphyllum



Hibiscus Syriacus



Amaranthus



Cestrum Diurnum



Hemigraphis Alternata



Caesalpinia Pulcherrima



Flacourtia Indica



Barleria Cristata



Wedelia Trilobata



Costus Speciosus



Alocasia

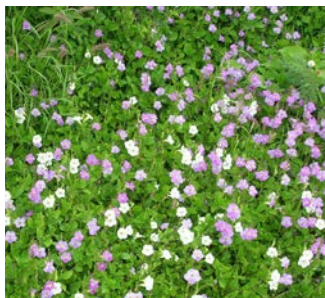

Asystasia Gangetica



Pilea Cadierei

source - from varies websites



Allamanda



Honeysuckle Vine



Jacquemontia Violacea



Bignonia Gracilis



Clerodendrum Thomsoniae

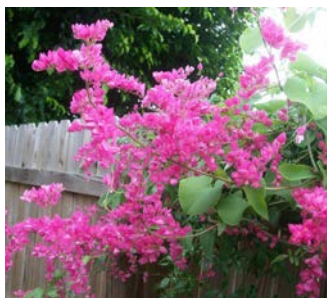

Antigonon



Thunbergia Grandiflora



Philodendron Monstera



Bougainvillea



Petrea Volubilis



Caesalpinia Crista



Ficus Repens



Ipomoea Palmata



Quisqualis Indica



Clerodendrum Splendens



Asparagus Sprengeri



Cymbopogon Flexuosus



Ophiopogon



Cortaderia Argentea



Phalaris Arundinacea



Chlorophytum Comosum



Pogonatherum Crinitum



Pennisetum Alopecuroides



Cynodon Dactylon



Dianella Grass



Saccharum Munja



Pennisetum Rubrum



Cyperus Alternifolius



Dwarf Pandanus



Asparagus Densiflorus



Pennisetum Setaceum



Typha Elephantina

source - from varies websites



Peacock



Indian Robin



Pigeon



Red Vented Bulbul



Rosy Starling



Myna



Squirrel

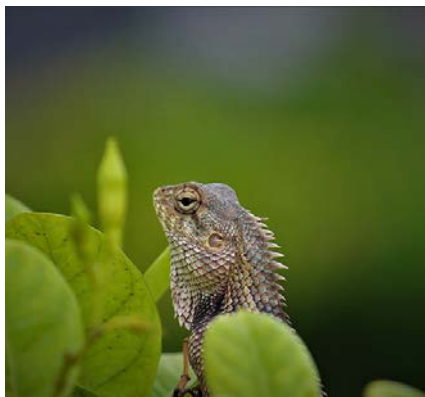

Kachindo



Bat

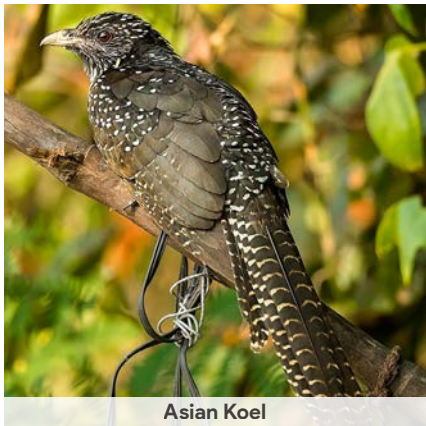

Asian Koel



Wren Warbler



Sunbird



Babbler



Tailorbird



Sparrow



Green Bee Eater



Black Drongo



Parakeet

source - from varies websites

Facts & Figures

11000

sq.m.

Forest park

250⁺

no. of plant
Species

4.77

Million

Liters

Volume of

Lake

30,000

New Saplings

planted

525 m.

Peripheral Forest Trail

Benches

45

250 m.

Nature
Trail

25

boulders

65

Existing
Trees

Dustbins

15

80

Light
poles



We invite you to visit 'Symphony Forest Park' and experience the mini forest - breath in fresh air, have a walk in the meandering trails while you spot birds, flowers, butterflies and squirrels.

Spend some time with yourself and nature, watching the sunset at the lake.



urbscapes